

TYPE:

DRAGON

R

ANTI-ABRASIVE VERTICAL PUMP FOR APPLICATIONS GRAVIOUS

FIELDS OF APPLICATION:

Special pumps for abrasive liquids from stone, aggregates, cement water, glass and ceramics.
Direct coupling via elastic coupling.
Flow rate up to 5800 l/min.

TECHNICAL FEATURES

AXIS: vertical with sealed chamber bearings dimensioned in such that the lower part of the shaft can work cantilevered without supports immersed in the liquid.
BODY: cast iron, split in two parts, coated with wear-resistant compound. Replaceable and adjustable antiabrasive rubber shells for quick maintenance
DISCHARGE CURVE: with interchangeable rubber sleeve for connecting the pump to the delivery hose.
IMPELLER: anti-clogging open metal that improves efficiency, allowing smaller engines the same performance.

OPTIONAL

On request, it is possible to insert an extension between the suction pad and the lower body bottom to increase the distance between bearing and liquid and keep the motor outside the bowl.



SECTORS

MARBLE
GRANITE
AGGREGATES
RECYCLING
MINING

MADE IN ITALY

OPERATING CHARACTERISTICS

PUMPS	FLOW RATE									SPEED [RPM]	MOTOR*
	m³/h	0	50	100	150	200	250	300	350		
	l/l'	0	834	1667	2501	3334	4168	5001	5835		
DRG 125 Ø 330	HEAD (m)	37	35,5	33	28	22,5				1450	30kw
DRG 125 Ø 350		42	40,5	38	35	31	26,5	22		1450	37kw
DRG 125 Ø 370		47	45,5	43,5	41	37,5	34	29,5	25	1450	45kw
DRG 125 Ø 400		54,5	54	52	49	46	42,5	38	33	1450	55kw

*Indicative data; measurement made with water; motor sizes and may vary when working with high density sludge.

DIMENSIONAL

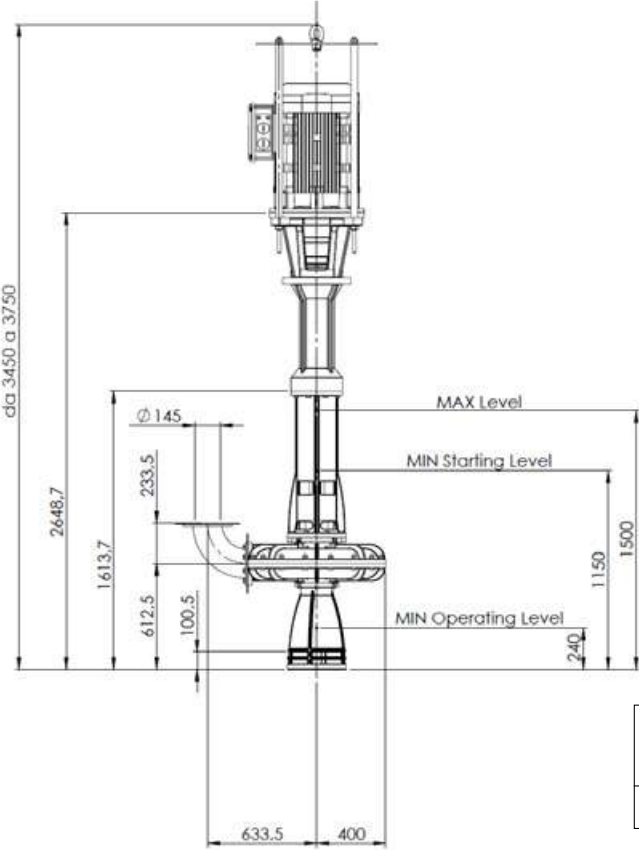
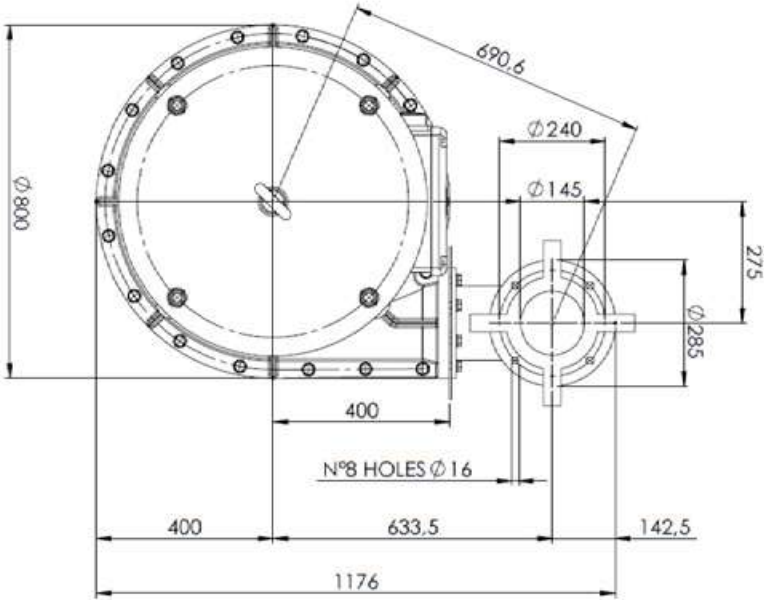

ALFA POMPE®

ITALIAN PUMPS FOR HEAVY DUTY SOLUTION

DIMENSIONAL DRAWING